

## Model: Post Supported LFS-FLA/LFS-FLCA

### Material:

- Extruded aluminum (6063-T6)

### Fabrication Method:

- Fully welded frame with mechanically fastened supports

### FLA - Standard Fascia Profile:

- 8", 12" in stock (Over 12" requires upper or lower extension)
- 6", 10" (check availability)

### FLCA - Channel Fascia Profile:

- 8", 12"

### Decking:

- 3" x 6" aluminum (6063-T6) interlocking pan
- M-Core corrugated metal sheet
- U-Panel corrugated metal sheet

### Water Dispersal:

- Include scupper (s)
- Include sleeve to accommodate downspout
- Aluminum gutter beam w/downspout
- Internal drainage through substructure/post (aluminum only)
  - Mouse hole drains w/diverter plates

### Width:

- Unlimited
- Frame sections of 24'0" – 30'0" max (if larger inquire)

### Support Post:

- Variable sizes
- Internal gutter
- Aluminum
- Galvanized steel
- Black steel

### Finish:

- AAMA 2603 Compliant Powder Coat 1 yr warranty
- AAMA 2604 Compliant Powder Coat 5 yr warranty
- AAMA 2505 Compliant Finish 10 yr warranty
- AAMA 2604 Compliant Special Wood Grain (aluminum interlocking pans only)
- 2-part Polyurethane Factory Applied Finish
- Kynar Finish Available Upon Request

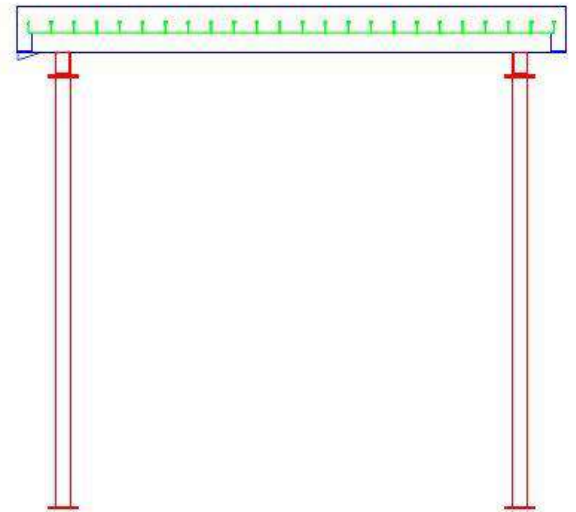
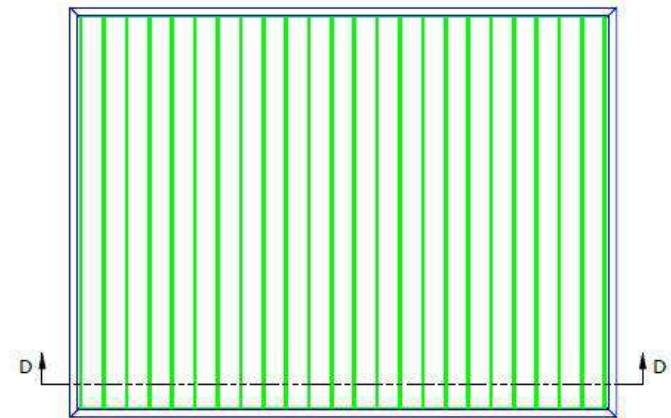

Call for any further details including but not limited to material, temper, thickness, paint and design.



# LFS-POST SUPPORTED FLA

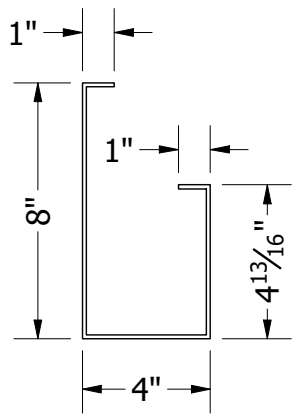
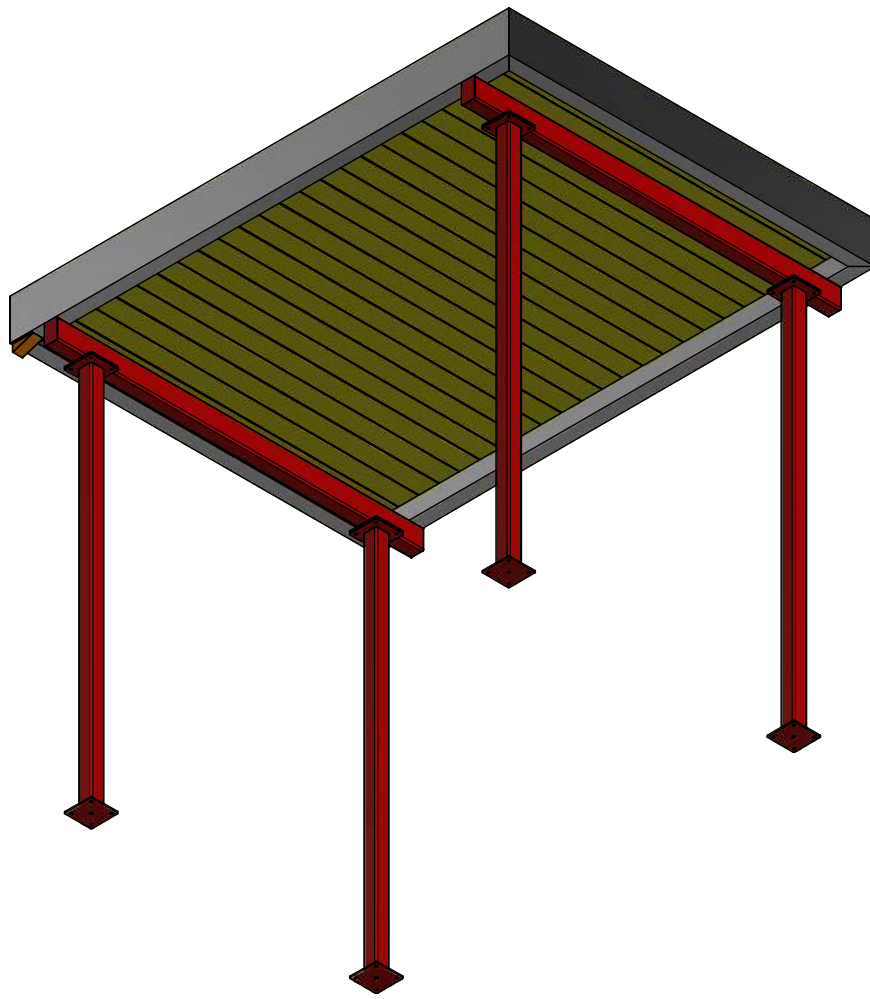
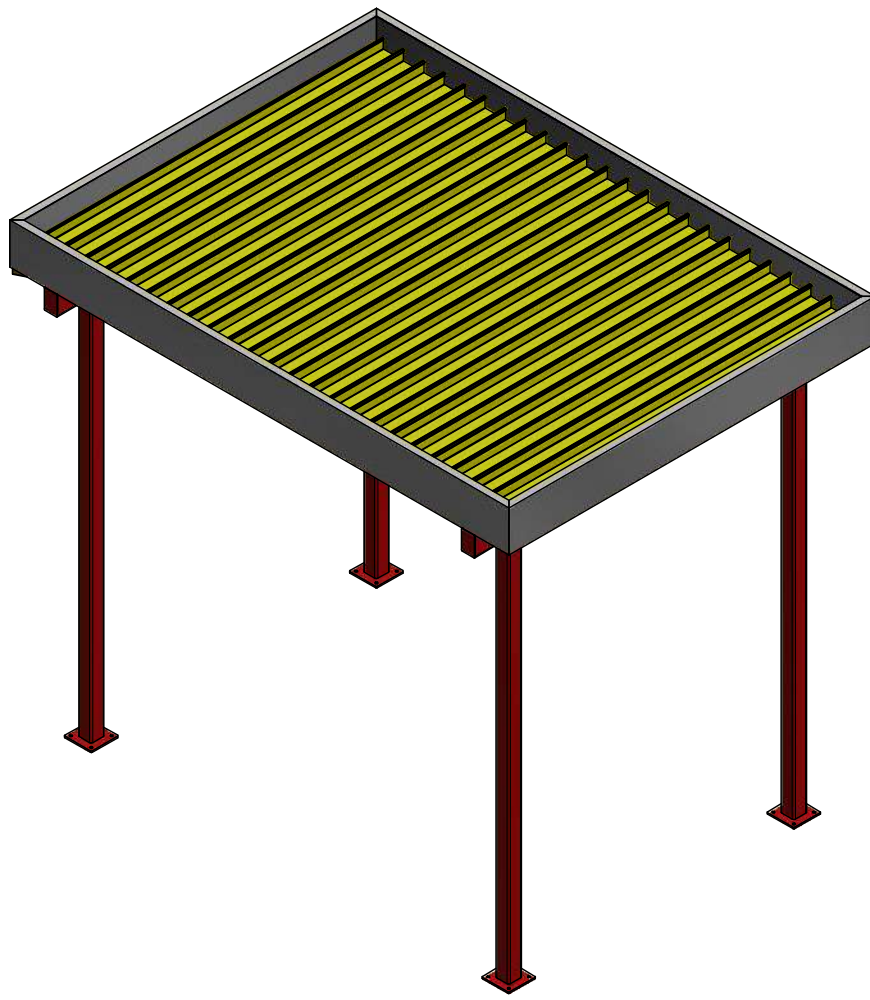

STANDARD 8" PROFILE

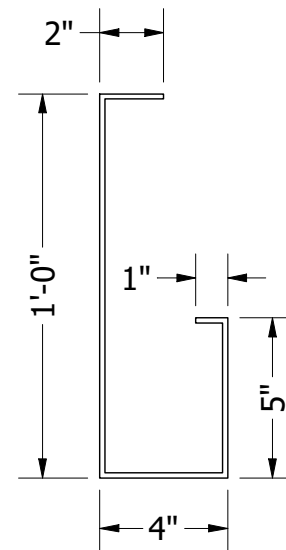

STANDARD 12" PROFILE

LFS-POST SUPPORTED FLCA

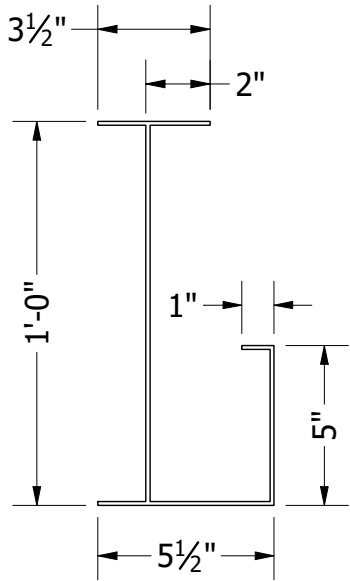
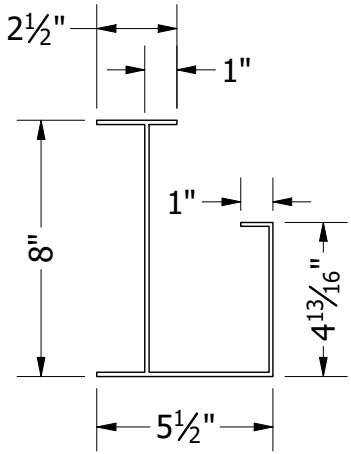
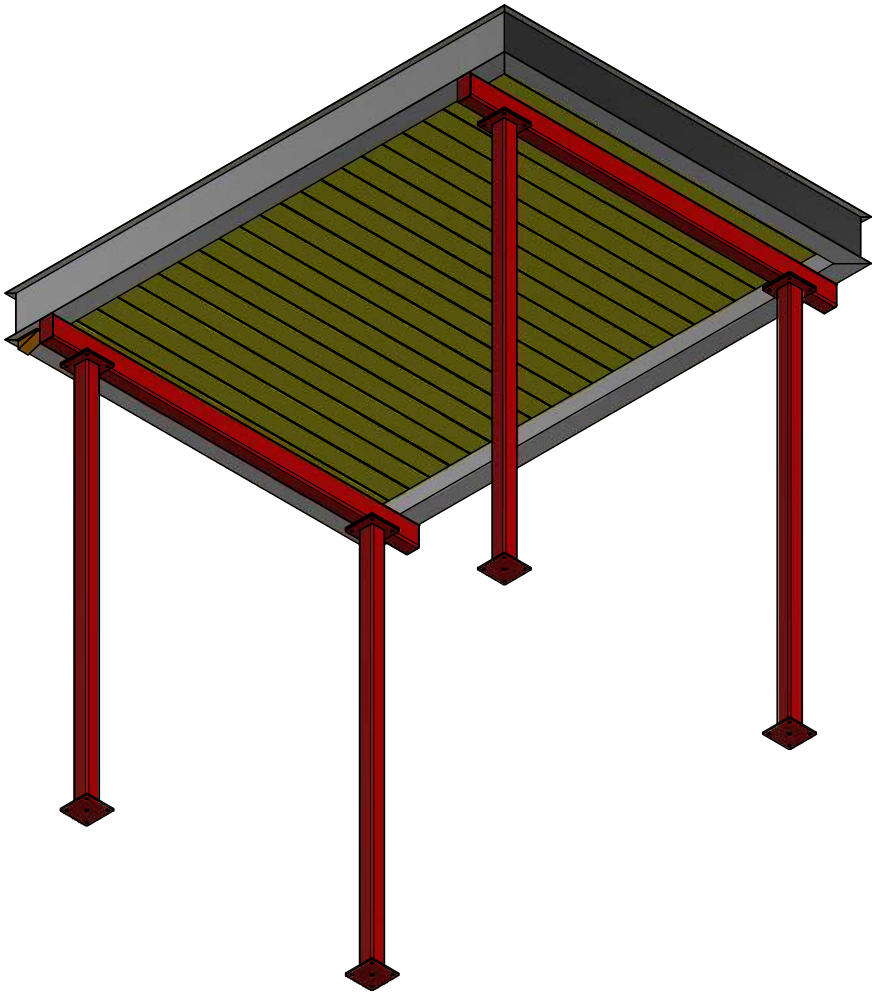
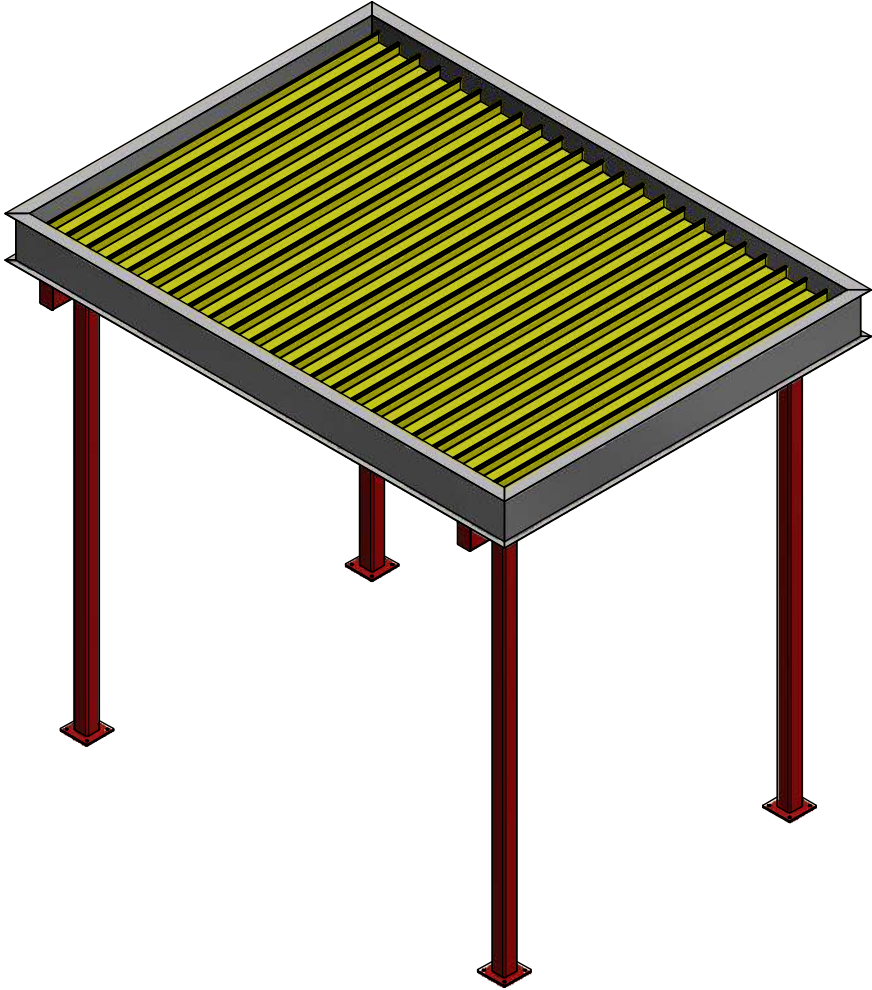

8" PROFILE WITH FLANGE

12" PROFILE WITH FLANGE

# METAL CANOPIES

**LAWRENCE**  
FABRIC & METAL STRUCTURES



**"YOUR IMAGINATION IS OUR VISION"**



Lawrence Fabric & Metal Structures, Inc || 3509 Tree Court Industrial Blvd., St. Louis, MO 63122  
Phone: (636)861-0100 || Fax: (636)861-0150 || Email: [sales@lawrencefabric.com](mailto:sales@lawrencefabric.com) || Web: [www.lawrencefabric.com](http://www.lawrencefabric.com)



An Employee Owned Company